

# MGP REAR SETS - YAMAHA YZF-R1/M 2015-16

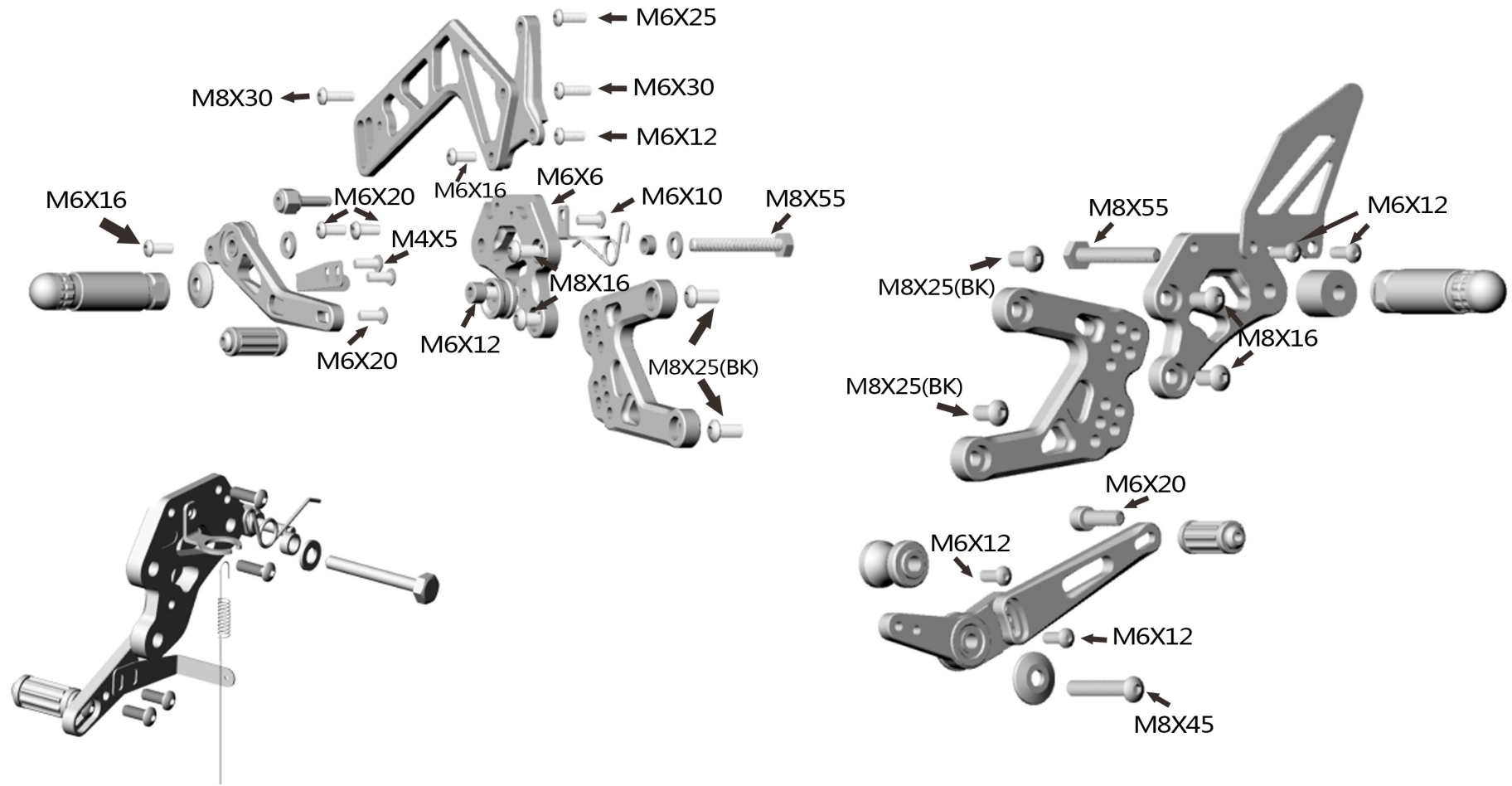

**! REMOVE PRE-ASSEMBLY O-RINGS BEFORE INSTALLING**

**! APPLY LOCKTIGHT TO ALL MOUNTING FASTENERS**



UNLESS OTHERWISE SPECIFIED, DIMENSIONS ARE IN INCHES .XX ± 0- .XXX ± 0.00- XXXX ± 0.000-		NAME	DATE	<b>MGP</b> <small>MOTORCYCLE PARTS</small>
ANGULAR ± ° FRACTIONAL ± ±	DRAWN	Bruce B.	04/01/15	
SURFACE FINISH ✓	CHECKED	Jeremy T.	04/02/15	
DO NOT SCALE DRAWING	APPROVED	Roger D.	04/03/15	
BREAK ALL SHARP EDGES AND REMOVE BURRS	TITLE			YAMAHA YZF-R1/M 2015-16 REAR SETS
THIRD ANGLE PROJECTION	MATERIAL	FINISH	SIZE	DWG NO.
	ALUMINUM	ANODIZED	81501-2500	REV. B
SCALE			WEIGHT	SHEET
			1 of 1	